

Connecticut Resources Recovery Authority - Hartford Landfill

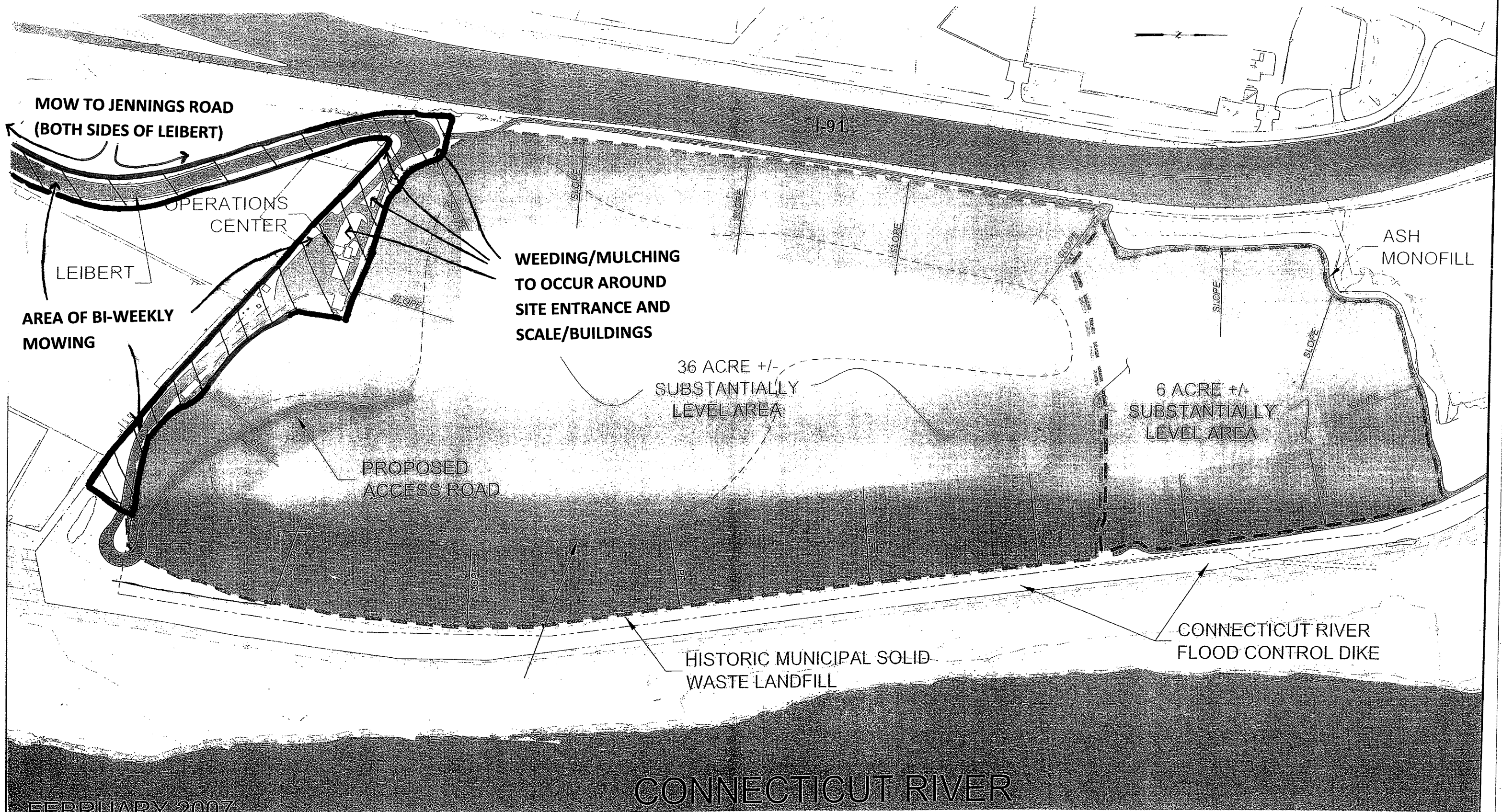

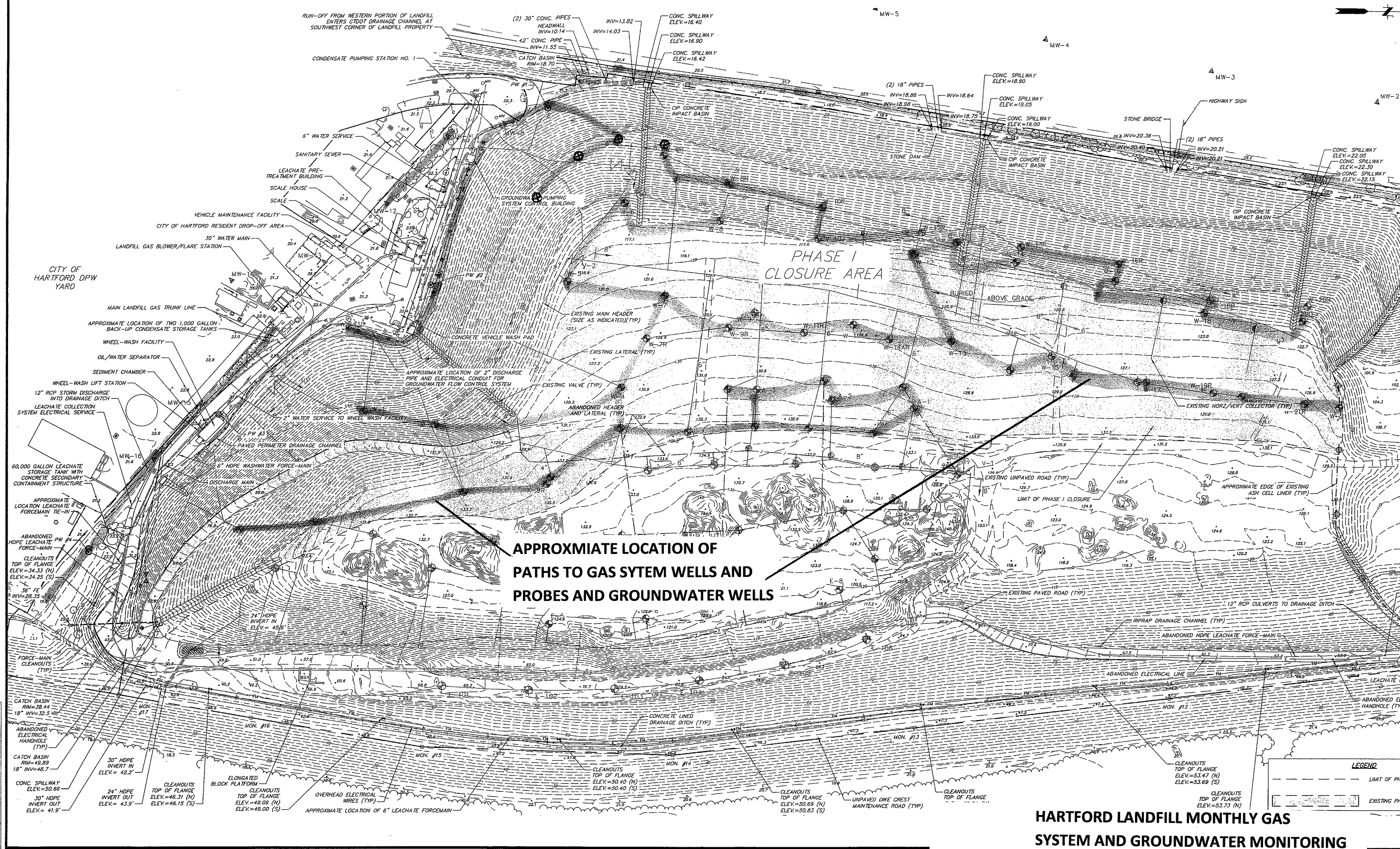

**APPROXIMATE LOCATION OF
PATHS TO GAS SYTEM WELLS AND
PROBES AND GROUNDWATER WELLS**

**HARTFORD LANDFILL MONTHLY GAS
SYSTEM AND GROUNDWATER MONITORING
WELL VEGETATION CONTROL**

G:\2010\12\14\20\CH\12420_EXC01.dwg, Layout: v.1.02, Plotted: Tue, Mar 06, 2012, 3:56 PM, User: kmegany, Plotter: DWG TO PDF.PC3, CTB File: FO_2008.MONO_COVER.CTB, LAYER: STATE

SEAL SEAL

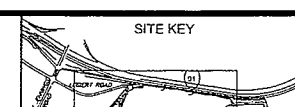

SCALE:
 HORZ. _____
 VERT. _____
 DATUM:
 HORZ.: NAD 27



PRJ. No.: 21
 DATE: MARC



Connecticut Resources Recovery Authority - Hartford Landfill

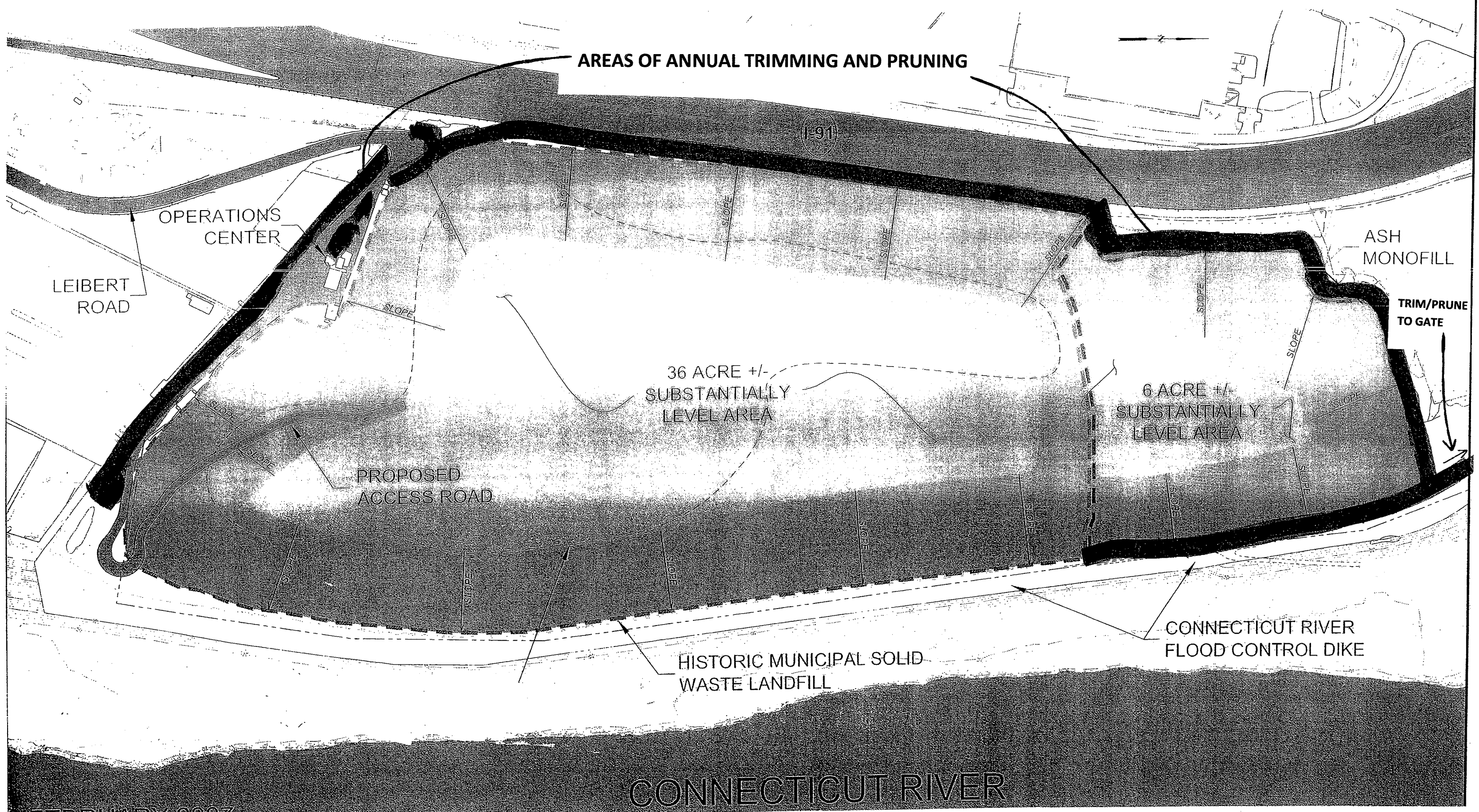

AREAS OF ANNUAL TRIMMING AND PRUNING

OPERATIONS CENTER

LEIBERT ROAD

36 ACRE +/-
SUBSTANTIALLY
LEVEL AREA

PROPOSED
ACCESS ROAD

HISTORIC MUNICIPAL SOLID
WASTE LANDFILL

6 ACRE +/-
SUBSTANTIALLY
LEVEL AREA

CONNECTICUT RIVER
FLOOD CONTROL DIKE

ASH
MONOFILL

TRIM/PRUNE
TO GATE

CONNECTICUT RIVER

AREA OF ANNUAL LANDFILL MOWING +/-62 ACRES

Connecticut Resources Recovery Authority - Hartford Landfill

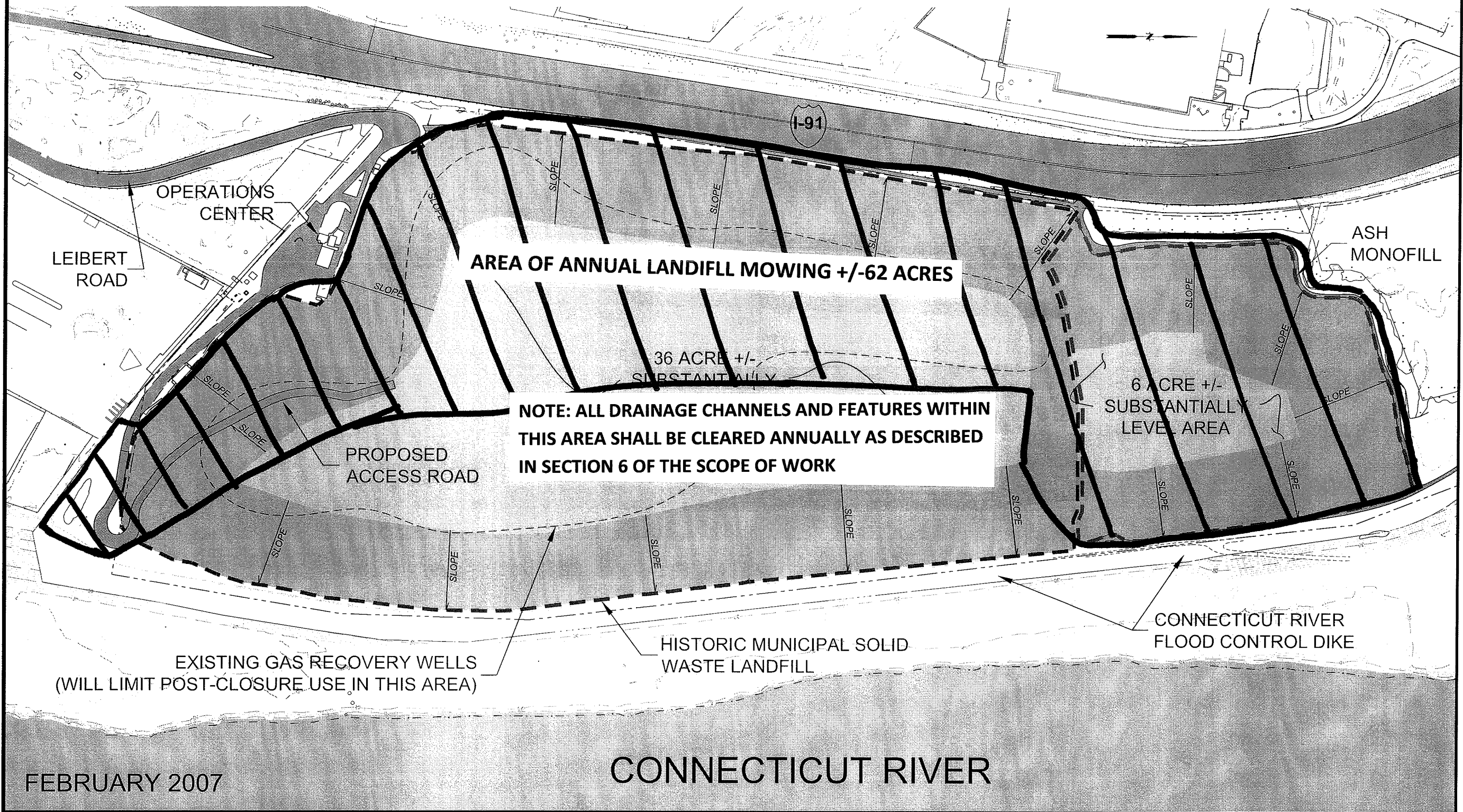

AREA OF ANNUAL LANDFILL MOWING +/-62 ACRES

NOTE: ALL DRAINAGE CHANNELS AND FEATURES WITHIN THIS AREA SHALL BE CLEARED ANNUALLY AS DESCRIBED IN SECTION 6 OF THE SCOPE OF WORK

EXISTING GAS RECOVERY WELLS
(WILL LIMIT POST-CLOSURE USE IN THIS AREA)

HISTORIC MUNICIPAL SOLID
WASTE LANDFILL

CONNECTICUT RIVER
FLOOD CONTROL DIKE

FEBRUARY 2007

CONNECTICUT RIVER